

Bone Drills

instruction manual

REF SP-002280/SP-002281/SP-002282

Model no:SMX-SU0018/SMX-SU0019/SMX-SU0020

General Description

The Power Drill makes light work of precision drilling and the accurate placing of bone screws in a variety of reconstructive and trauma procedures. Featuring a 4 mm cannulated channel for pins and wires, the device is given additional stability by attaching a left or right torque control handle which is included with the drill. Supplied with a keyless chuck, the Drill comes pre-sterilised and ready to use.

This pack includes: 1 Power Drill unit
1 Chuck Key
1 Instruction Manual

Instructions for Use

1. Peel open the pack and remove all of the items.
2. Released keyed chuck jaws first, attach the required drill bit to the chuck and locked chuck by key until the connection is tight and secure. **(A H)**

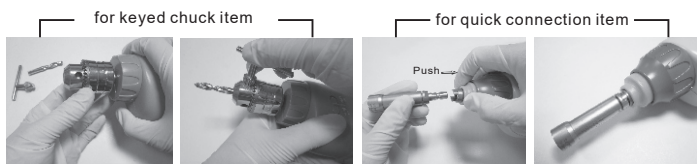

3. **Sterile Person-** Open the cover and put Transfer(Funnel) on the top. **(G J)**
4. **Non-Sterile Person-** Place battery pack and take the Transfer(Funnel) out of the battery box. **(I J)**
5. **Sterile Person-** Close the cover.

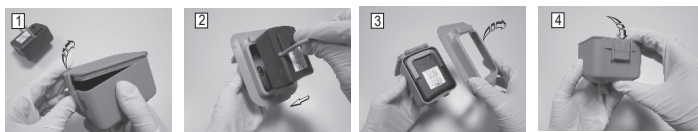

6. Install the battery box in the tool and secure connection.



7. Push UP the speed button for Drilling operation (High Speed) . **(C)**
Push DOWN the button for Screwing operation (Low Speed).

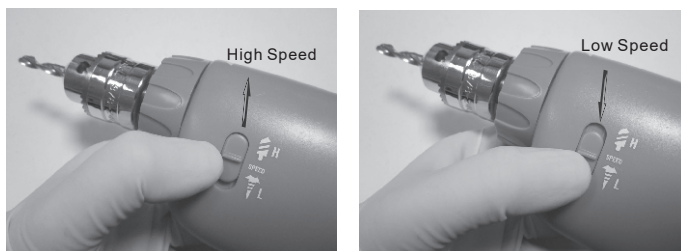

8. Rotate switch Ring on " F " for Forward direction or switch on " R " for Reverse direction. **(B)**

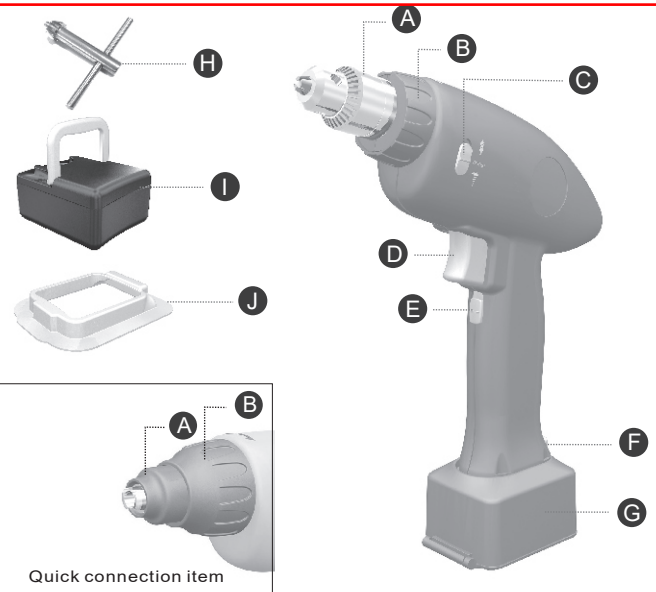
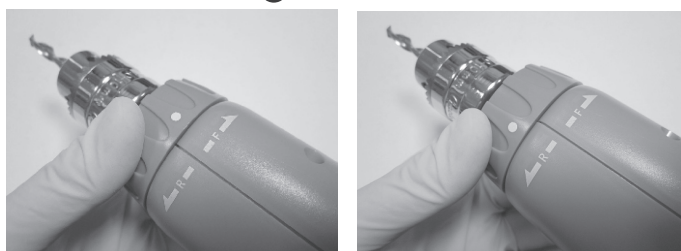

Read the operating instruction carefully before use. Failure to follow may cause damage or injuries.

Ready to operation

1. Ensure Power source is ready to connection.
2. Slide down the safety switch. The Power Tool is now ready to use. **(E)**
3. Activate the Power Tool by pressing the speed control trigger. **(D)**



4. When finished using the Power Tool, lift the Speed Control trigger, slide up the Safety Switch.
5. Before removing the drill bits or saw blade ensure the Power disconnection.

Battery Pack Removal:

- Push switch to OFF mode **(E)** , depress the latch and slide battery pack out of the handpiece. **(F G)**
- Always remove battery pack when not in use.



Specification

- Drill Torque 1.8 Nm / Screw Torque 1.8 Nm
- Drill Speed 1000 RPM / Screw Speed 250 RPM
- Forward & Reverse Rotation
- With Cannulated design, diameter is 4.5mm.

⚠ Caution

International law restricts this device to sale by or on the order of a physician.

⚠ Warnings

Excessive heat is the most likely cause of patient injury. Any power instrument is subject to overheating, especially in the nose section. Even normal operation of the system in cycle other than 2 minutes "ON" and allowing the handpiece to cool to room temperature may cause the handpiece to become hot.

Power Input- By Power Console

1. Peel open the Power Cord pack and remove all of the items.
2. Ensure the power console switch at OFF position first , put power cord plug into bottom of hand piece power socket until the connection is secure.



3. Put power cord another end plug into power console " " socket. Switch Power ON for ready the operation.

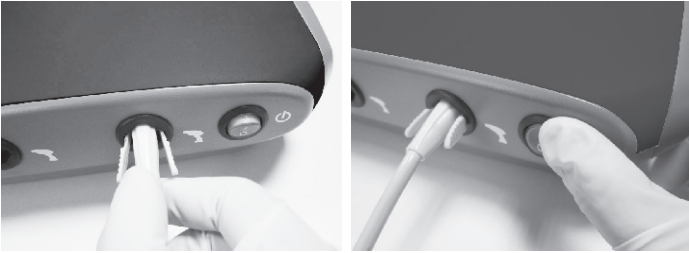

Battery Pack Charging

LED Indicator Signal Table

	STATUS (Red/Green LED)
Stand-by (Battery Pack Disconnected)	Constant Green
In Charging	Constant Red
Charging Completion	Constant Green
Charger Failed	Flash Red

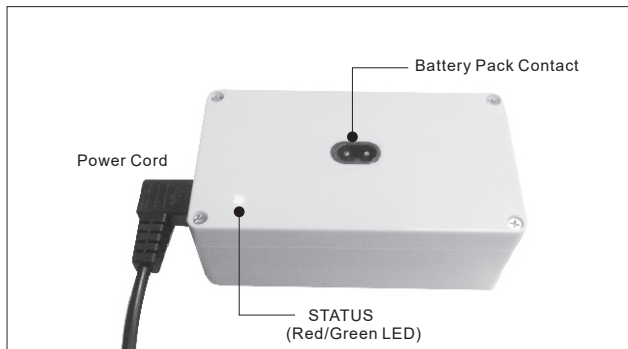

1. Plug one end of the AC power cord to charger first and then the other end of AC power cord to the electrical outlet. The power LED will turn into Green as the charger passes the power on test.
2. Connect the input of Li-Ion battery pack to the charger Contact. The Status LED will turn into constant RED and the charging starts.



3. The status LED will stay RED until battery pack is fully charged and when the charging is completed, the status indicator will turn GREEN.

First Time--Please charge battery pack until Charger turns green.

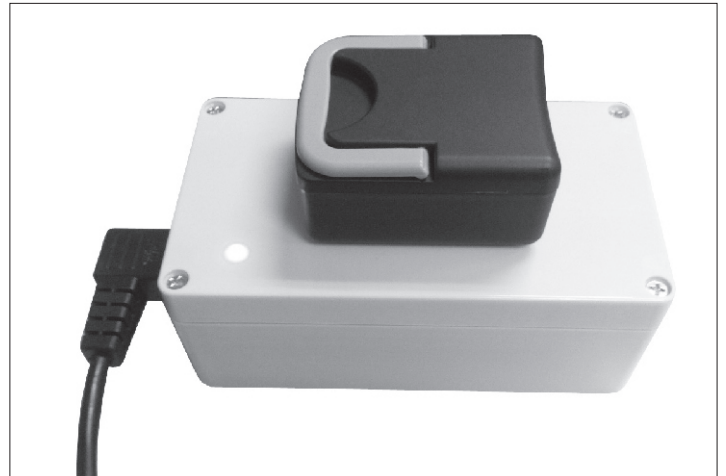

Charger Specifications

1. Input: 100~240VAC, 50/60 Hz.
2. Output : 12.6V 2A DC.
3. Charger output: The charger is preset by factory for charging 3 cells Li-Ion battery pack.

⚠ Caution

1. Make sure battery pack is compatible with charger before connecting.
2. Never use this charger to charge a non-rechargeable battery.
3. DO NOT dispose battery in fire.

⚠ Warnings

- Sterile only if package is unopened and undamaged.
- Ensure that the device is disposed of safely and in accordance with all current national and international waste disposal directives.
- Store in a cool dry place.
- Single use only! DO NOT Re-sterilize!

Labeling Symbols

 Refer to instruction manual/booklet

 General warning sign / Caution

 Do not use if package is damaged

 Do not re-use

 Keep dry

 Temperature limit

 Sterilized using ethylene oxide

 Complies with EU directives

 Manufacturer

 Premature unpacking warning

 Type BF applied part  Medical Device

 Direct current  Catalog number

 Use by date  Batch code

 Date of manufacture **S/N.** Serial number

 Consult instructions for use

 European Union WEEE Directive Logo

 Recycle Li-ion battery

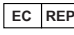
 Authorized representative in the European Community

 UK Responsible Person

 Please dispose of the device in accordance with EC Directive – WEEE (Waste Electrical and Electronic Equipment).